

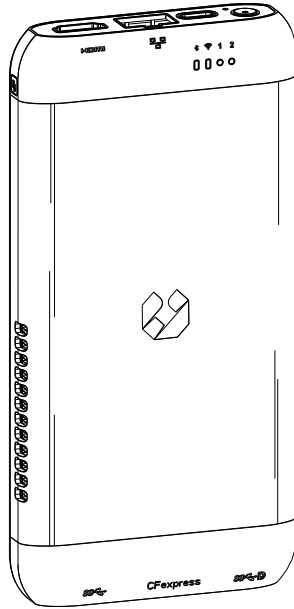

## Product User Manual



UnifyDrive UT2

# What is UnifyDrive

## Personal Cloud Storage at home

With faster speeds, larger storage capacity, and enhanced data security, you'll never have to worry about file deletions or privacy breaches again. Enjoy VIP-level storage service for the whole family or company. Free up phone space and store millions of photos and thousands of HD videos, eliminating storage anxiety.

## Your Family Photo Album

With an integrated AI photo album, disorganized photos are categorized by person, time, scene, and location, sparing you the trouble of searching through countless pictures. The baby album captures every step of your baby's growth by time and place can be shared effortlessly with family and friends.

## Your Reliable Work Assistant

With online office document editing, Mac Time Machine backups, automatic synchronization of files across multiple computers, and easy sharing of large files, it is perfect for personal use or team collaboration, removing the barriers of space and distance to maintain work efficiency.

## Your Personal Online Entertainment Center

With built-in tools for cloud storage download and PT download, you can conveniently access a wide range of resources. Store your favorite music, TV shows, treasured movies, and memorable anime and novels in your personal cloud. With an internet connection, you can stream them remotely on your phone, computer, or TV. Your personal cinema, accessible anywhere.

## Your Trusty Data Guardian

Say goodbye to chaotic flash drives and external hard drives. UnifyDrive is your anytime-accessible, non-portable external hard drive, allowing you to store all your photos, videos, files, and documents in one place. It helps you efficiently store, conveniently manage, and easily use your data.

## Reliable Data Security Guard

From hardware to software, protect your data privacy and security comprehensively. Utilizing local storage, multi-layer encryption, account space isolation, and file vaults, your data is safer in the private cloud, avoiding data leaks and hard drive failures.

# Device Description

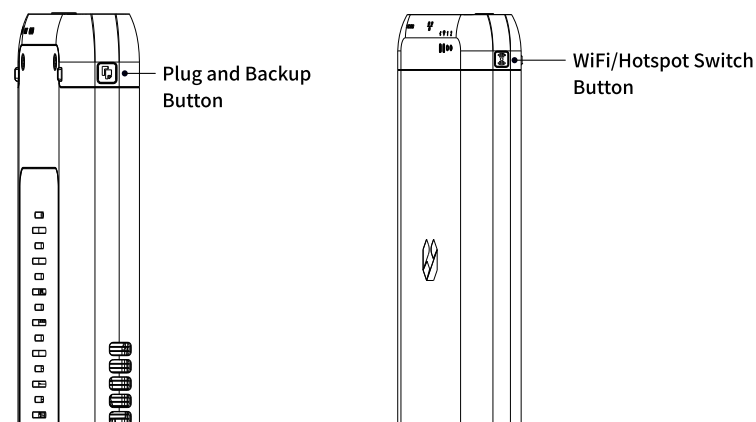
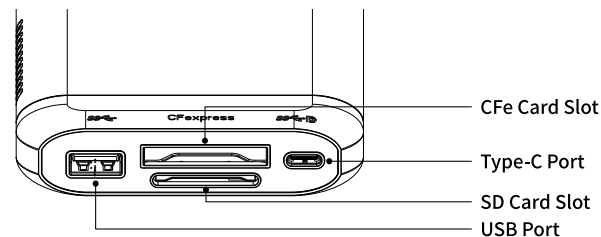
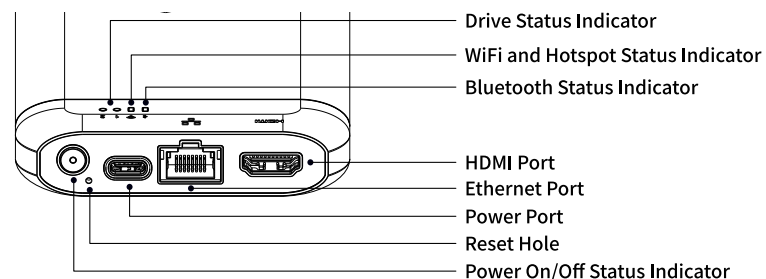

# Device Description

## Device List

Device	x 1	Remote Control	x 1	Power Adapter	x 1
Ethernet Cable	x 1	HDMI Cable	x 1	Dual-Head Type-C Cable	x1
Screwdriver	x 1	Silicone Case	x 1	User Manual	x1
Warranty Card	x 1	Accessory Pack	x 1		

## Built-in UPS Instructions

1. This device is equipped with an internal UPS. Use it in appropriate conditions and avoid high temperature or humidity.
2. The UPS is partially charged upon leaving the factory. If the charge is under 15%, the device will not start without external power. Pressing the power button will emit two "beep" sounds.
3. When UT2 has only UPS power supply, power light and status light will turn yellow and there would be a beep.

## Important Notice

1. Newly added drives must be formatted before being used in a storage pool. Ensure data is backed up.
2. Do not install or remove drives while the device is powered on, as this may lead to data loss or drive damage.
3. Use the power button to turn the device on and off properly. Unplugging the power directly may damage the device or hard drive.
4. UnifyDrive shall not be liable for any device or data damage caused by improper operation.



To ensure optimal performance and longevity of the device, please avoid operating it in environments with excessive moisture or high temperatures.

# Hard disk installation

For the internal hard disk version,  
go to the Device Activation page

# Standard Version SSD Installation

(For any built in drive versions please refer to the page of 'device activation' )

## Hard drive installation instructions:

### Standard Version (hard drive was not attached) SSD Installation

#### 1. Compactability of SSD models:

1. UT2 is compactable with SSD with M.2 interface and dimensions in 2280 (22\*80mm).
2. PCIe 4.0 protocol is not compactable.



#### 2. Notifications of SSD daily usage:

1. SSD with M.2 connector may be overheated due to its property. In case of such potential damage, please leave the device in a good air venting and cooling environment especially when there is an expected constant reading or writing demand.
2. SSD has got varied working temperatures through different brands and models. For detailed guidance, contact customer service representatives from each brand and avoid extended operation at excessively high temperature.



Scan QR code for video usage guide

# Installing the hard disk - Step

Standard no hard disk version, please install the hard disk as follows

#### ① Back Cover Removal

Use a screwdriver to unscrew the screws of the back cover of the device.

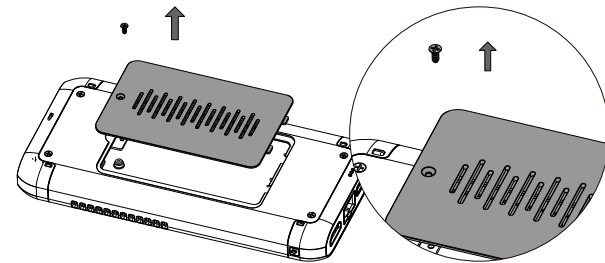

#### ② SSDs Installation

Insert the SSDs at an angle as illustrated, and then tighten the screws to secure it in place.

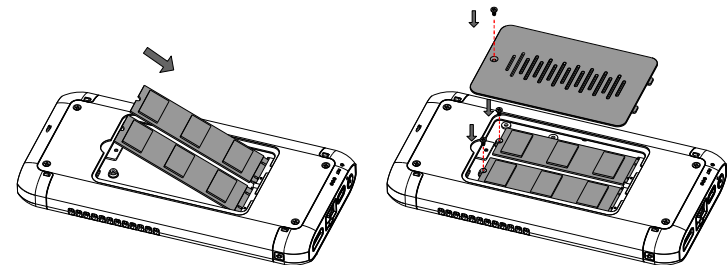

# DEVICE ACTIVATION - NETWORKING AND STARTUP

## ① Network connection

Please connect the device and router with ethernet cable which you may find in package box

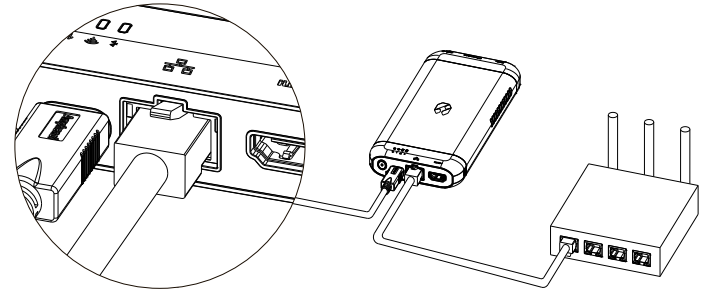

Refer to page 15 for Wi-Fi setup instructions if Ethernet connection is not convenient.

## Device Activation

## ② Power connection

Plug one end of the Type-C cable into the red circled port, and the other into the adapter, then connect it to a power socket.

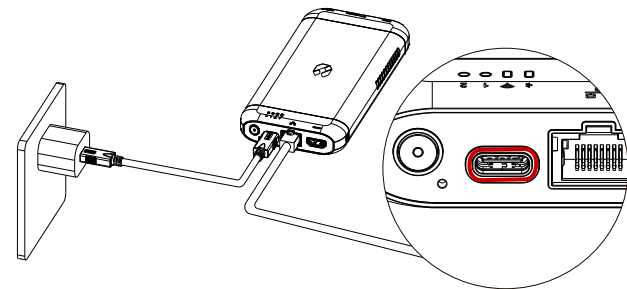

### 3. Startup the device

Tap on the power button and you will turn on the device with a beep and a lit power light.

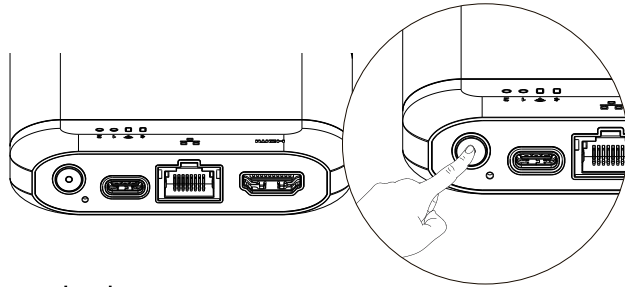

### 4. Status check

It takes around 1 minute to configure the device, please check the status after that.

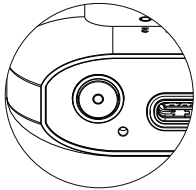

#### Status check

If the status indicators display red after powering on, it indicates a network connection issue. Please check the network connection and the router status.

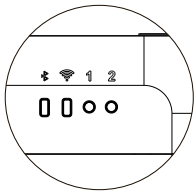

#### Hard drive indicator lights

Those indicator lights should be steady and red shortly after starting up the device. (Suggesting hard drive is identified and ready to work) If those indicator lights never come up when hard drive is installed and device started up 6 minutes earlier, please shutdown the device and check the hard drive. Then, you may reinstall the hard drive and repeat the start up procedure.

\*For more indicator status, please refer to the 'indicator lights instructions' at page 23.

#### Important Warnings:

1. The Type-C port with the red circle is designed for 9V/12V PD protocol power supplies only. Do not use it for USB data transmission.
2. The device is equipped with a built-in UPS. Ensure it is used in an appropriate environment and keep it away from high temperature or humidity.
3. Such electronic device may cause environmental pollution and electromagnetic interference.
4. Using non-certified power adapters or UPS units may result in device failure, abnormal operation or even severe damage.

## Device Activation - Registration

### Step 1: Download and install the "UnifyDrive" app on your mobile device.

Search for "UnifyDrive" in your phone's app store, use your phone browser to scan the below QR code to download.

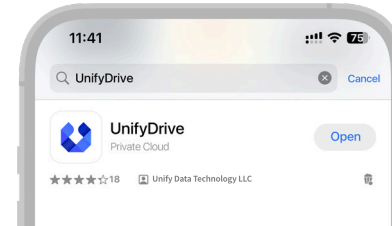

### Step 2: Connect to the Device

Make sure the cellphone and UnifyDrive are connected to same local network. Please find UT2 device according to followed steps.

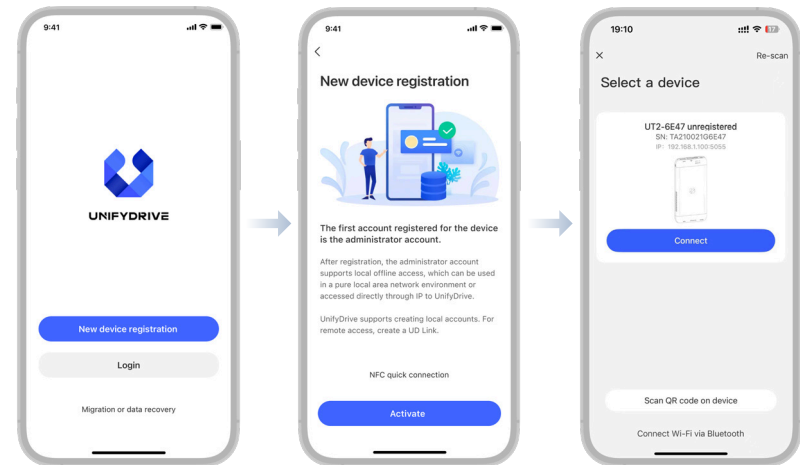

## Explanations on the possible scenarios

### Scenario 1: Unable to find the UnifyDrive within local network.

Trouble shooting with the help of the notifications listed; Clicking on 'scanning device QR code' to the lower of the application.

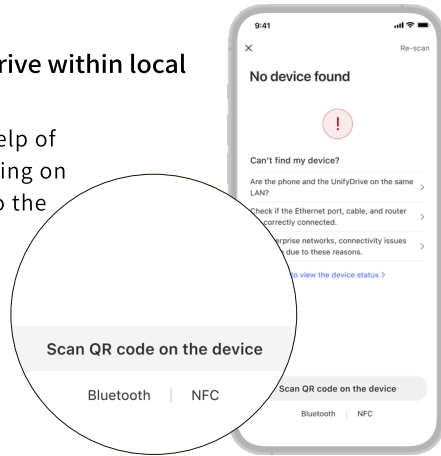

### Scenario 2: The device needs further upgrade to register the account.

Upon initial setup and network connection, there may be a prolonged upgrade process with the power status indicator blinking rapidly. Please do not turn off or unplug the power and network cables at this time, as it may result in system damage and hinder normal use.

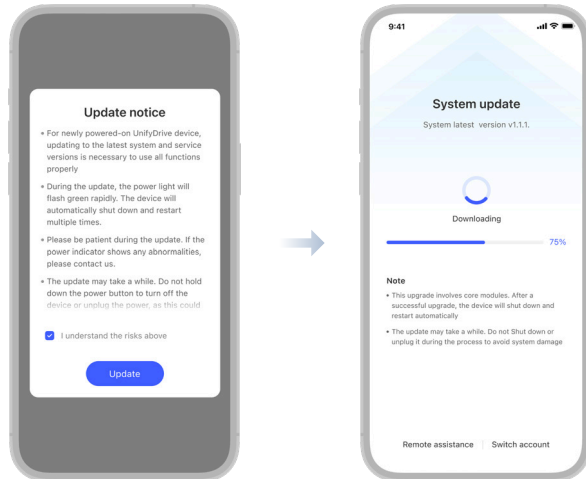

## Registration Completion and UnifyDrive Initialization

After completing the registration, click to log into UnifyDrive and follow the on-screen prompts to complete the setup of the storage pool and other initialization operations.

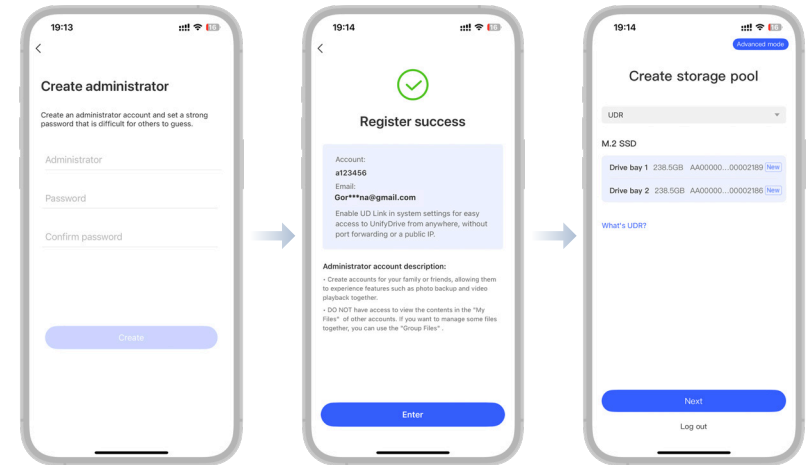

### Notifications:

1. All the data shall be removed through the formatting process;
2. Please contact us via email or phone if you are finding any issues with initialization process;
3. UnifyDrive has got many options for storage pool, please check the advanced setting for more options.
4. UnifyDrive would suggest you with (UDR mode) for storage. With such mode, you may be able to select the important data to be backed up and secured in dual copies. Compared with RAID1 full backed up mode, UDR mode has met the security demand and utilized the hard drive to the maximum.

# Function Introduction

## Multi-terminal Services

### Computer Desktop Client

UnifyDrive is compactable with Windows and Mac devices, please download from our official website [unifydrive.co](http://unifydrive.co)



### TV Client

UnifyDrive is compactable with both Android TV and Apple TV. Please download from our official website or Android store.

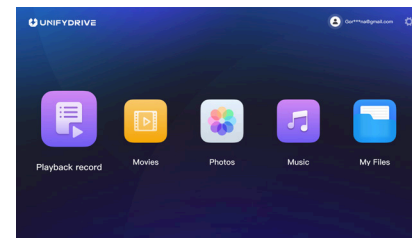

### Computer Web browser

UnifyDrive is compactable with varied browser to enter [ud.link](http://ud.link)

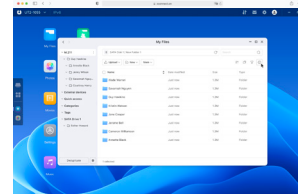

### Viehive Interactive Device

UnifyDrive is compactable with several vehicle interactive devices and you may download through the app stores. (We are still working on better compatacibility)

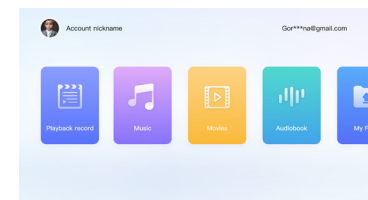

### Cellphones and Pads

UnifyDrive is compactable with varied cellphones and pads, please download through app stores.

\*The actual performace may varied through different divices;



# WiFi Connection for the Device

UT2 can be connected to the internet using WiFi when Ethernet connection is not convenient.

## Wifi Connection

1. Open the UnifyDrive mobile app and find 'Connect Wi-Fi via Bluetooth' on the login page.
2. Access the appropriate page by selecting 'Connect Wi-Fi via Bluetooth'.
3. Find the UT2 device you want to connect to WiFi and press the Configure Wi-Fi button.
4. Choose the WiFi network you wish to join, enter the password, and complete the setup process.

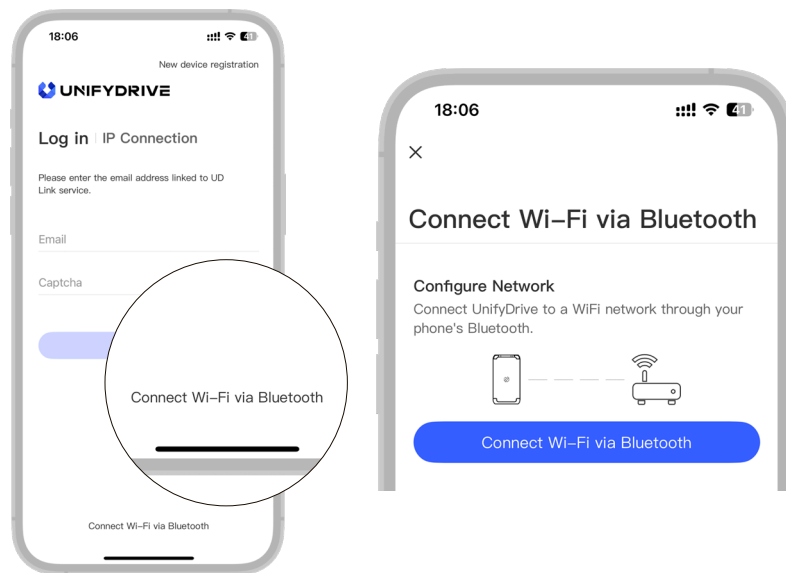

### If you're unable to find the UnifyDrive device via Bluetooth:

Check whether HDMI is connected (Bluetooth status indicator lighting up). Disconnect HDMI if connected, as network configuration is not possible while it's connected. Try turning Bluetooth off and on again, reopening the UnifyDrive app, restarting your phone, restarting UnifyDrive and then try again.

# WLAN Hotspot Configuration

UT2 supports WLAN hotspot functionality, effectively allowing it to act as a router. Other devices can connect to UT2 to access the internet, or access UT2 through Apps without internet connection.

## WLAN Hotspot Configuration:

1. Open the UnifyDrive mobile app and find 'Connect Wi-Fi via Bluetooth' on the login page.
2. Access the appropriate page by selecting 'Enable WLAN Hotspot'.
3. Find the UT2 device you intend to configure the WLAN hotspot for and select the WLAN hotspot button.
4. Proceed to the configuration page and input necessary details, such as password setup.

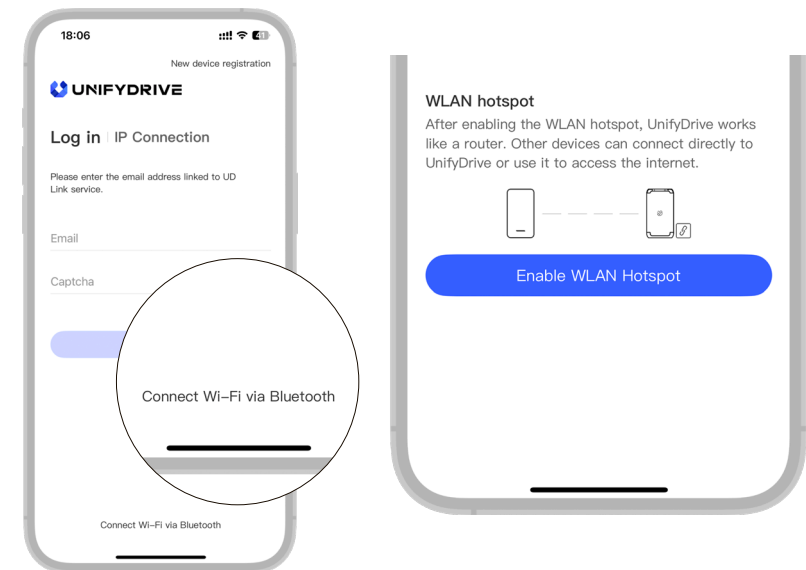

### WLAN Hotspot Information:

1. WLAN's transmission performance cannot match that of professional routers or exchangers.
2. When the phone connects to the UT2 hotspot and the UT2 device is not connected to the internet, the UnifyDrive app will require direct IP access or offline login to establish a connection.
3. After the phone connects to the UT2 hotspot and logs into the device via

# WiFi and WLAN Hotspot Switch

The UT2 supports one-click switching between WiFi and WLAN hotspot. Prior to using the device's button for switching, it is recommended to configure WiFi and WLAN hotspot through the mobile app.

## WiFi and WLAN Hotspot Switch Button

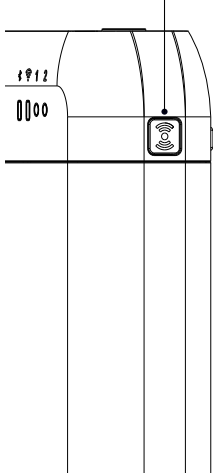

**When the indicator light is off, WiFi and WLAN hotspot are disabled.**

Press the  briefly to enable WiFi mode, connecting automatically to the last used WiFi network.

**When the indicator light is on, WiFi or WLAN hotspot is enabled.**

Press the  briefly to switch between two modes. The corresponding indicator light will turn on after a successful switch.

**Press and hold the  for 3 seconds to turn off WiFi and WLAN hotspot.**

\*A "beep" sound will accompany the action as confirmation.

Color	Status	Description
Blue	No Blinking	WiFi enabled and connected
Green	No Blinking	WLAN hotspot enabled
Blue	Slow Blinking	WiFi enabled but no network access
Off	None	WiFi and hotspot disabled

### Default WLAN Hotspot Password

When you activate the WLAN hotspot using the device button, the default password is **12345678**. Please update this promptly in the mobile app's system settings. The access point is named "UT2-XXXX," where "XXXX" represents the last four digits of the device ID.

# Virtual Device

The UT2 supports running multiple virtual devices simultaneously. One UT2 device is equivalent to several phone operation systems, allowing you to play games, browse TikTok, listen to music, and check messages.

## Usage Virtual Device:

Access the "Virtual Android" feature from the "More Apps" section on the homepage of the UnifyDrive app. Tap the icon to enter and follow the on-screen instructions to start using it easily.

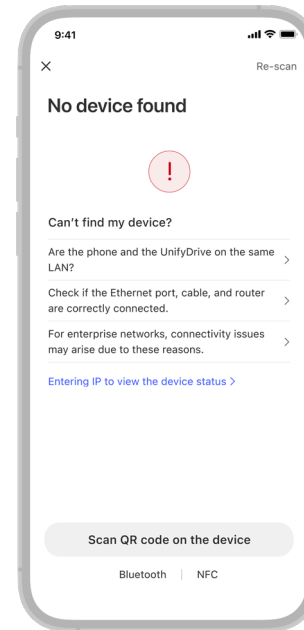

Note: Images are for illustrative purposes only.

### Relevant Notice

1. Theoretically, UT2 can run up to 6 virtual device systems simultaneously. However, the actual number depends on the device's load, resource utilization and the consumption of each virtual device. Excessive load or resource consumption may result in lagging or even crashes.
2. Virtual Device is intended for personal entertainment purposes only and should not be used for any other activities. UnifyDrive bears no responsibility for any legal consequences resulting from misuse.

# Flash Drive Mode Instructions

Utilize UT2 as a Flash drive by following these steps:

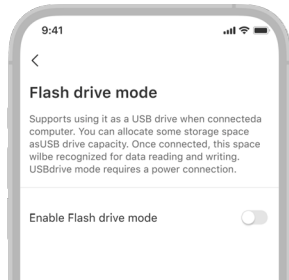

## ① Flash Drive Capacity Setting

After completing administrator registration and establishing a storage pool, go to "Settings" -> "Flash drive mode" to configure the capacity.

## ② Computer Connection

Connect to your computer via UT2's Type-C data port to use it as a Flash drive.

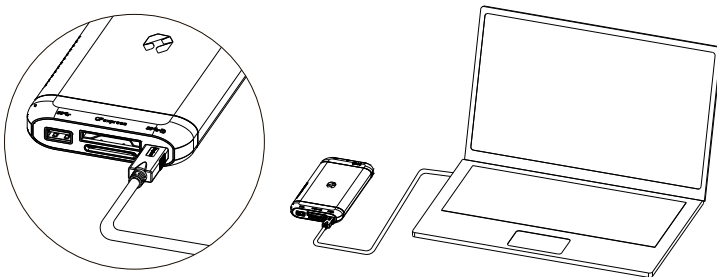

\*UT2's Type-C data port supports auxiliary power supply. With the internal UPS charged, you can boot it up and use it as a Flash drive by plugging in the Type-C cable. It's important to note that the duration of usage without external power varies depending on the power output capacity of the USB ports on different computer models.

## Flash Drive Mode Usage Guidelines

1. The storage allocated in flash drive mode acts as an external Flash drive within UnifyDrive space.
2. Flash drives cannot be accessed simultaneously by both the computer and UnifyDrive. Once connected to the computer, UnifyDrive loses access to the flash drive space.
3. If the flash drive isn't recognized by the computer, try restarting UnifyDrive after connecting the USB cable.
4. Choose the file format for the flash drive setup carefully, as NTFS format may not be recognized by certain Windows systems.

# SD/CFexpress Card Plug and Backup

UT2 supports plug-and-backup for SD/CFe cards. Simply enable this feature in the app to automatically backup data upon inserting an SD or CFe card.



PlugBackup

## ① Enable the Feature in the App

Find the "PlugBackup" application within the app and activate the instant backup feature.

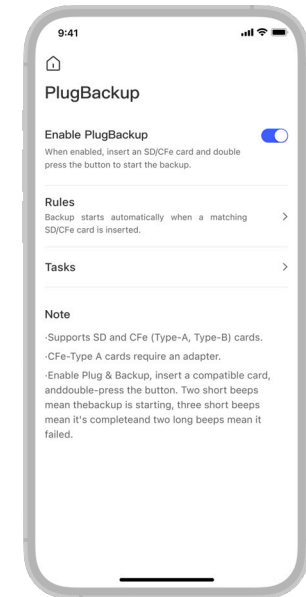

PlugBackup Button

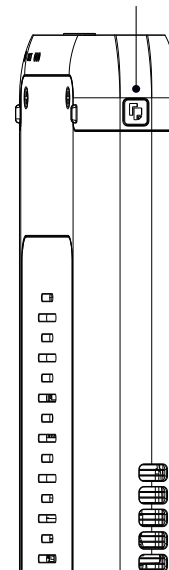

## ② Double-Tap the Button

Press the button 2 times after inserting the SD or CFe card to start automatic backup.

### Relevant instructions

- Backup initiation: 2 beeps.
- Backup completion: 3 beeps.
- Backup initiation failure: 2 long beeps.

# HDMI/Type-C Output

UT2 offers the capability to output video or desktop services to the respective display endpoint using both the HDMI port and TypeC data port.

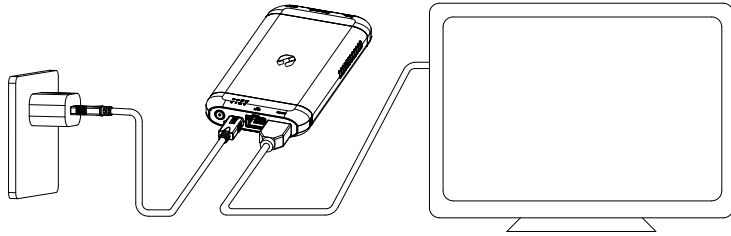

- \*The HDMI port on the device end may be labeled as HDMI-in, HDMI-Out, or HDMI-ARC. If labeled, please plug it into HDMI-in.
- \*TypeC output supports dual-head C, C-HDMI, and C-DP data cables.
- \*HDMI supports 8K 60 frames, while TypeC supports 8K 30 frames output. 8K output requires synchronized support from output devices, data cables, and display devices. Please inquire with the seller when purchasing related equipment.
- \*UT2 supports 8K UHD (resolution 7680\*4320) but does not support 8K DCI (resolution 8192\*4320)

## Mobile App Streaming

Access the "Movies" detail page within the mobile app and select the "HDMI" button to output content to your monitor using HDMI. The mobile app will concurrently act as a remote control.



## Desktop Application Output

The desktop requires the use of the included Bluetooth remote control. Please ensure the remote control is paired before use.

Once the device and remote control are successfully paired, you can operate the application desktop.

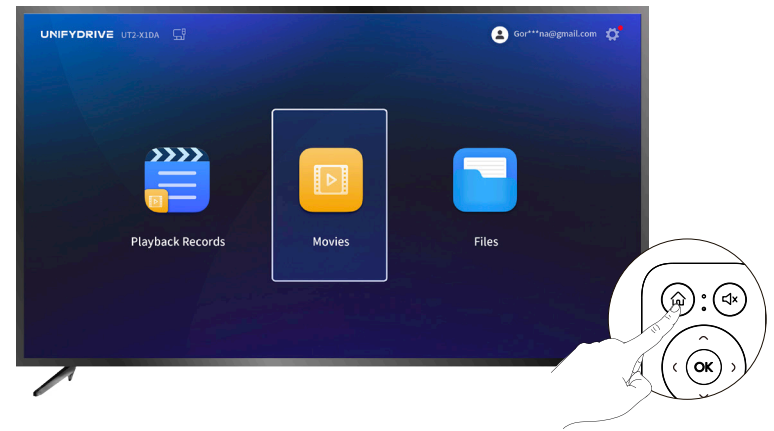

## DP Output

It is compatible with various AR and VR glasses to provide a massive screen viewing experience.

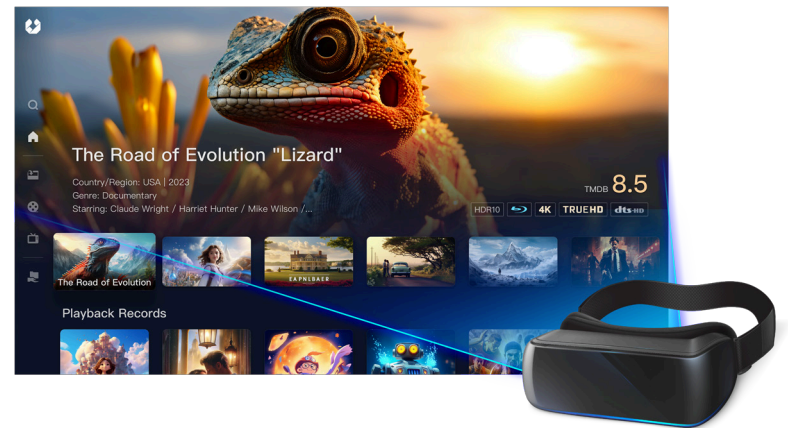

# Remote Control Pairing Instructions

HDMI or Type-C output desktop applications require the remote control for operation. The following are the steps to pair the UT2 device with the remote control.

## Initial Pairing

When the display device is correctly connected to the UT2 device, the Bluetooth pairing function will activate automatically (the Bluetooth status indicator will remain solid red, indicating it's ready for pairing). Place the remote control within 0.5 meters of the device and simultaneously press and hold the OK and  to start pairing. The status indicator will turn solid blue once pairing is successful.

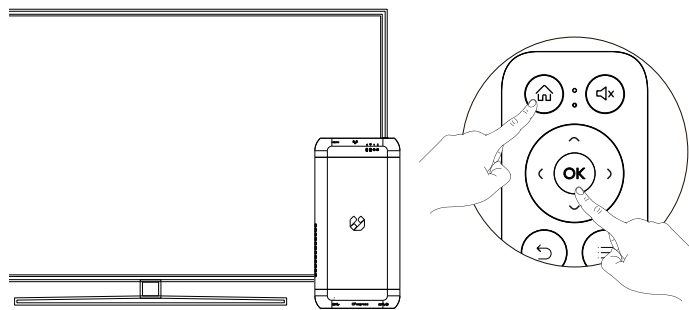

## Re-pairing

If the buttons on the remote control stop working after pairing (with the blue indicator blinking slowly), or if you want to pair a new remote control, please access "Settings" - "HDMI Desktop" on the mobile app and initiate the "Bluetooth Remote Control Pairing" process.

## Bluetooth Status Indicators:

**Solid Red:** awaiting pairing with remote control.

**Slow Red Blinking:** retrieving data from paired remote.

**Solid Blue:** remote control paired successfully.

**Slow Blue Blinking:** remote control in sleep mode or awaiting activation.

**No Light:** pairing function inactive.

\*When HDMI is inserted correctly, the Bluetooth indicator will turn on, preventing Bluetooth networking pairing. To initiate networking pairing, remove the HDMI cable and wait for the Bluetooth indicator to turn off.

\*The effective range of the Bluetooth remote control is 3 meters. Ensure there are no obstructions and maintain this distance during use.

# Indicator Light Guide

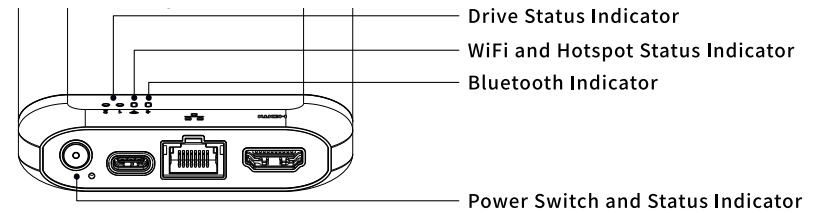

Name	Color	Status	Description
Power Status Indicator	Off	N/A	Powered off
	Green	No Blinking	Powered on, external power supply
	Green	Fast Blinking	System upgrade
	Green	Slow Blinking	Password reset
	Yellow	No Blinking	UPS Power Supply Only
	Red	Slow Blinking	No network connection or network error
	Red	Fast Blinking	Other Serious Malfunction
Drive Status Indicator	Green	No Blinking	Normal State
	Green	Fast Blinking	Drive Read/Write
	Green	Slow Blinking	Drive Sleep
	Red	Slow Blinking	Formatting in Progress
	Red	No Blinking	Waiting for Processing
	Red	Fast Blinking	Drive Failure
	Off	N/A	No Drive Detected
Bluetooth Status Indicator	For detailed status and description, please refer to the "WIFI Connection for the device" and "Remote Control Pairing Instructions" sections.		
WiFi and Hotspot Status Indicator	For detailed status and description, please refer to the "Wifi Connection and WLAN Hotspot Configuration" section.		

## Power off the UnifyDrive device

Press and hold the power button for 4 seconds to initiate a safe shutdown. During the shutdown process, all three lights will blink rapidly in green simultaneously.

## Administrator password reset

Press and hold the reset button for 4 seconds. During the password reset process, the status indicator will blink slowly in green.

## Factory reset setting

Press and hold the reset and power button simultaneously. During the reset process, all three lights will blink rapidly in red. Factory reset won't erase data from the drive.

\*If the indicator lights are disabled in the system settings, follow the system settings.

# UnifyDrive Service



## Automatic Backup of Mobile Photos

Mobile photo albums are backed up automatically. Intelligent tool categorizes photos based on people, scenes, time and location. Family sharing albums allows family members to view photos together.



## Online Video Streaming

Online streaming supports mainstream video formats. Within the same local network, it supports Blu-ray and 4K streaming.



## Instant File Sharing

Access and share files from UnifyDrive anytime and anywhere. It's like having a fully functional, high-capacity, always-online laptop with you wherever you go.



## Online Documents Editing

Enjoy the convenience of editing office documents online by using both computers and mobile devices, with support for nearly all types of office documents.



## Two-way Cloud Storage Backup

Download data to UnifyDrive and encrypt files before uploading to cloud storage.



## Real-Time Documents Syncing

You can automatically sync designated content from your office computer to UT2, and also ensure timely synchronization of office files across multiple office computers.



## Group Files

"Family Files" offers controlled group usage permissions and file read/write permissions for team members, with a recycle bin mechanism in place to prevent malicious file deletion.

# Account and Data Relevant Instructions

## What is an administrator?

The first account created upon device setup becomes the administrator. Administrators can create other user accounts and have higher-level hardware management permissions, allowing them to restrict access to certain hardware features for other accounts.

## What is a local offline account?

Local offline account is stored entirely on the user's local drive, and no information is stored or accessed by the UnifyDrive cloud service. These accounts can only be accessed within a local area network environment and have limited access to UnifyDrive cloud services. Local offline accounts can be upgraded to regular accounts usable on both the internet and local networks.

## What is a regular account?

Regular accounts can only be registered using email. The UnifyDrive cloud service maintains a record of the association between regular accounts and UnifyDrive, enabling access to UnifyDrive under various network conditions. Regular accounts can also be used in a pure local area network environment.

## Can administrators view regular account contents?

UnifyDrive adheres to strict data security and privacy policies. Each user's content in their "My Files" is completely isolated from others, and administrators cannot view the content of other users. In "Group Files", administrators can set the team groups each user can access and the file read-write permissions for each group. Administrators can view the content uploaded by other users to "Group Files" and supervise their related activities in "Group Files".

## Who has access to the shared content once it's been set up?

In "My Files", users can choose to share folders with either all users or specific individuals. If shared with specific users, only those designated individuals have permission to view and download the shared content. However, they do not have the ability to edit or delete the shared files.

## User Data Privacy Protection

Protecting user data and maintaining user privacy are fundamental principles at UnifyDrive. We do not share any user information with external parties without explicit consent from the user. More information is available in the UnifyDrive Service Agreement and Privacy Policy.



**UNIFYDRIVE**



[www.unifydrive.com](http://www.unifydrive.com)

